

Lever mod. Y-SA002

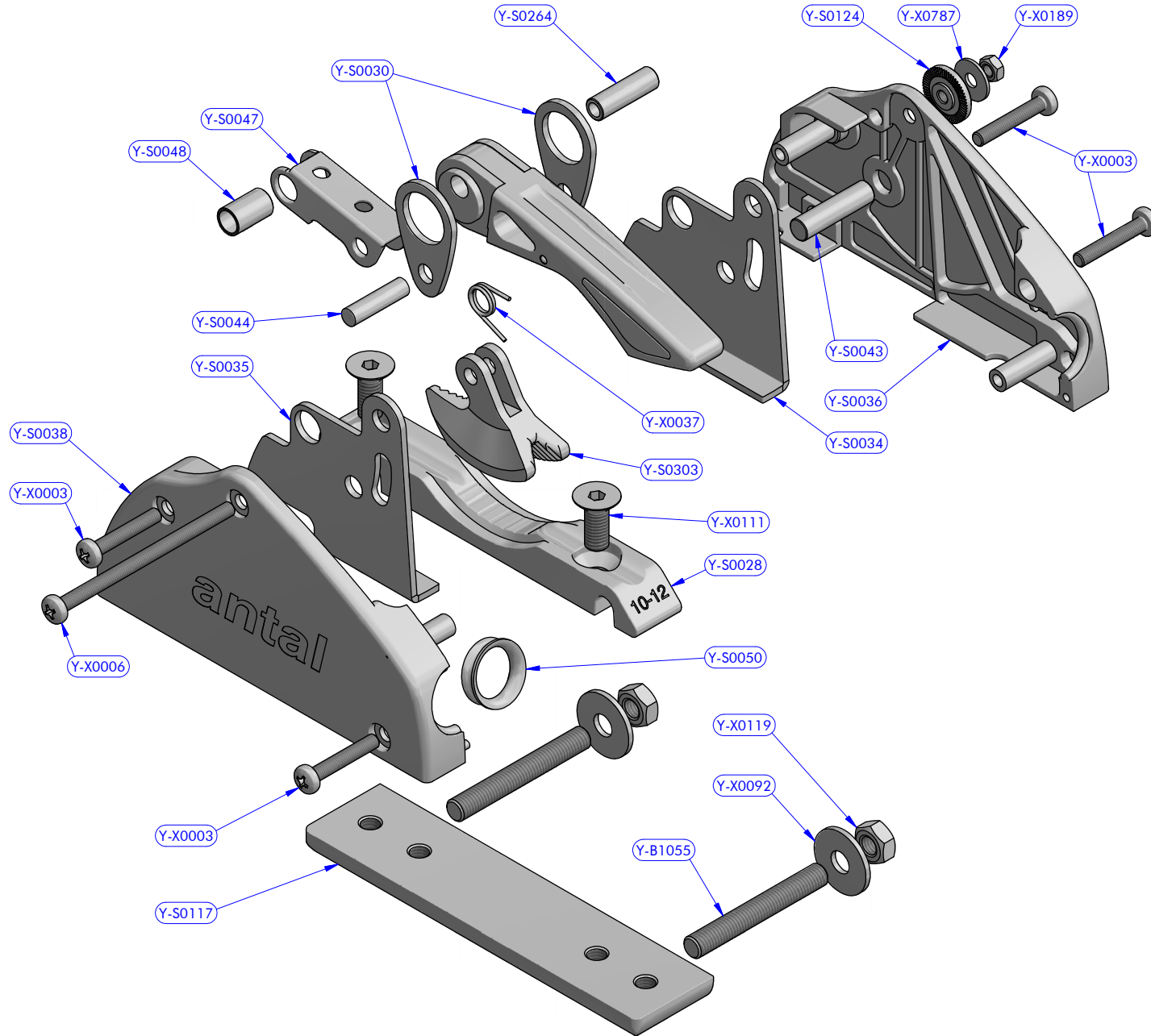

| PART LIST | | | |
|-----------|------------------|-----------|------|
| CODE | DESCRIPTION | MATERIAL | Q.TY |
| SFD008 | Delrin ball 1/8" | Plastic | 2 |
| Y-B1055 | Stud | S.Steel | 2 |
| Y-S0028 | Base | Aluminium | 1 |
| Y-S0030 | Connecting rod | S.Steel | 2 |
| Y-S0033 | Lever cap | Plastic | 1 |
| Y-S0034 | Right side plate | S.Steel | 1 |
| Y-S0035 | Right side plate | S.Steel | 1 |
| Y-S0036 | Cheekplate | Plastic | 1 |
| Y-S0038 | Cheekplate | Plastic | 1 |
| Y-S0039 | Lever insert | Plastic | 1 |
| Y-S0041 | Lever | Aluminium | 1 |
| Y-S0043 | Spindle | S.Steel | 1 |
| Y-S0044 | Spindle | S.Steel | 1 |
| Y-S0047 | Cam bracket | S.Steel | 1 |
| Y-S0048 | Pipe spacer | S.Steel | 1 |
| Y-S0050 | Ring | S.Steel | 1 |
| Y-S0117 | Base | Aluminium | 1 |
| Y-S0124 | Skirt washer | S.Steel | 1 |
| Y-S0264 | Pipe spacer | S.Steel | 1 |
| Y-S0303 | V-Grip Cam | S.Steel | 1 |
| Y-X0003 | Screw | S.Steel | 4 |
| Y-X0006 | Screw | S.Steel | 1 |
| Y-X0037 | Torsion spring | S.Steel | 1 |
| Y-X0092 | Washer | S.Steel | 2 |
| Y-X0111 | Screw | S.Steel | 2 |
| Y-X0119 | Nut | S.Steel | 2 |
| Y-X0189 | Nut | S.Steel | 1 |
| Y-X0787 | Washer | S.Steel | 1 |



| | |
|------------------|--------------------|
| V-Cam 814 Series | Horizontal version |
| FAMILY | ARTICLE |
| Exploded view | |
| DESCRIPTION | |

| |
|------------------|
| 509.112/H |
| MODEL CODE |

| | |
|------------|-------|
| 25/06/2019 | 00 |
| DATE | REV. |
| 19062510 | 1 / 1 |
| DWG N. | PG. |